



SOLUTIONS FOR FLOW CONTROL

KAVAL INDUSTRIES

www.kaval.ca



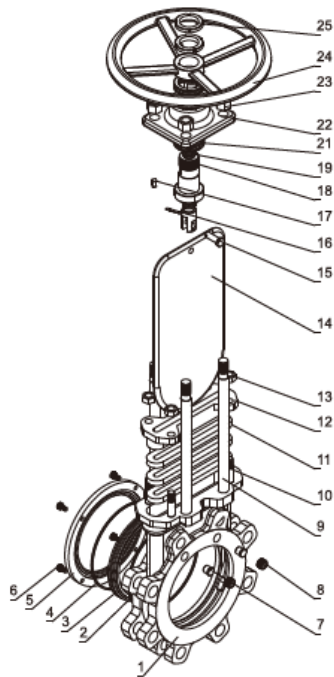

Item	Part	Standard Material		
		A216 WCB	A351 CF8	A351 CF8M
1	Body	A216 WCB	A351 CF8	A351 CF8M
2	Seat	13Cr	304ss	316ss
3	O-Ring	NBR	NBR	NBR
4	O-Ring	NBR	NBR	NBR
5	Seat Retainer	WCB	304ss	316ss
6	Screw	CS	304ss	316ss
7	Guide Poles	PTFE	PTFE	PTFE
8	Screw	CS	304ss	316ss
9	Bonnet Pole	CS+Cr Plated	CS+Cr Plated	CS+Cr Plated
10	Bolts	CS	304ss	316ss
11	Stem Packing	PTFE	PTFE	PTFE
12	Gland Flange	A216 WCB	A351 CF8	A351 CF8M
13	Nut	CS	304ss	316ss
14	Gate	13CR	304ss	316ss
15	Straight Pin	CS	CS	CS
16	Split Pin	SS	SS	SS
17	Flat Key	1045	1045	1045
18	Stem Nut	D2	D2	D2
19	Stem	13CR	13CR	13CR
21	Bearing	Bearing Steel	Bearing Steel	Bearing Steel
22	Bearing Seat	WCB	WCB	WCB
23	Nut	CS	CS	CS
24	H.W	D.I	D.I	D.I
25	Nut	CS	CS	CS

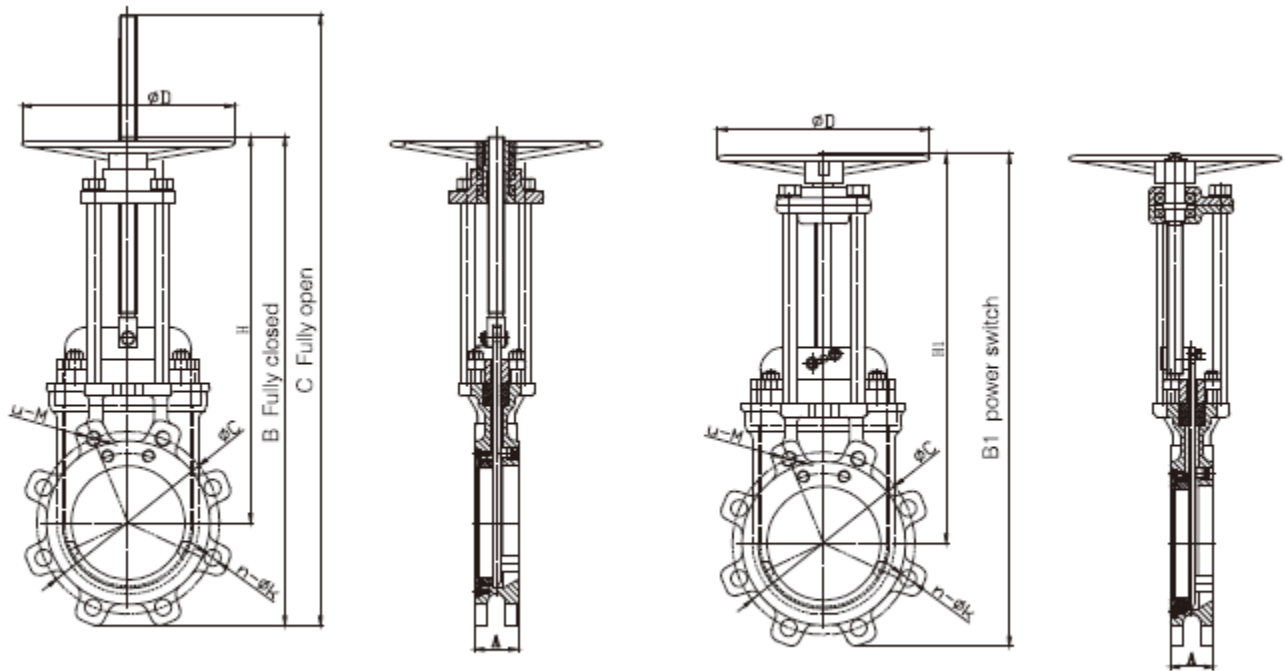

Outside screw rising stem type

Inside screw nonrising stem type

DN	A	H	B	C	D	H1	B1	PN16			150Lb	
								E	n-φK	u-M	E	u-M
50	48	300	365	350	180	310	375	φ 125	2-φ 18	2-M16	φ 120.5	4-5/8-11NC
65	48	310	380	375	200	320	390	φ 145	2-φ 18	2-M16	φ 139.5	4-5/8-11NC
80	51	370	460	450	220	380	470	φ 160	6-φ 18	2-M16	φ 152.5	4-5/8-11NC
100	51	410	514	625	240	402	510	φ 180	6-φ 18	2-M16	φ 190.5	8-5/8-11NC
125	57	457	578	715	260	461	582	φ 210	6-φ 18	2-M16	φ 216	8-3/4-10NC
150	57	510	645	805	280	514	650	φ 240	6-φ 22	2-M20	φ 241.5	8-3/4-10NC
200	70	613	775	985	300	623	785	φ 295	8-φ 22	4-M20	φ 298.5	8-3/4-10NC
250	70	737	940	1200	340	737	940	φ 355	8-φ 26	4-M24	φ 362	12-7/8-9NC
300	76	850	1075	1385	380	845	1070	φ 410	8-φ 26	4-M24	φ 432	12-7/8-9NC
350	76	970	1228	1580	400	970	1228	φ 470	10-φ 26	6-M24	φ 476.3	12-1-8NC
400	89	1090	1382	1795	450	1090	1382	φ 525	10-φ 30	6-M27	φ 540	16-1-8NC

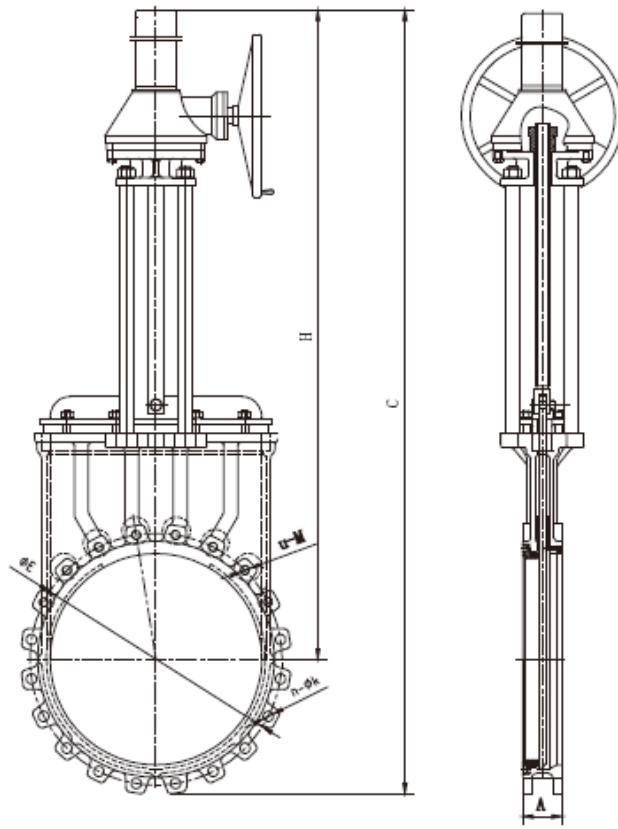

DN	A	H	C	PN16			150lb	
				E	n-φK	u-M	E	u-M
200	70	885	1060	φ 295	8- φ 22	4-M20	φ 298.5	8-3/4-10NC
250	70	1000	1280	φ 355	8- φ 26	4-M24	φ 362	12-7/8-9NC
300	76	1250	1460	φ 410	8- φ 26	4-M24	φ 432	12-7/8-9NC
350	76	1390	1610	φ 470	10- φ 26	6-M24	φ 476.3	12-1-8NC
400	89	1570	1850	φ 525	10- φ 30	6-M27	φ 540	16-1-8NC
450	89	1770	2070	φ 585	12- φ 30	8-M27	φ 578	16-1 1/8-7NC
500	114	1900	2240	φ 650	12- φ 33	8-M30	φ 635	20-1 1/8-7NC
600	114	2180	2540	φ 770	12- φ 36	8-M33	φ 749.3	20-1 1/4-6NC

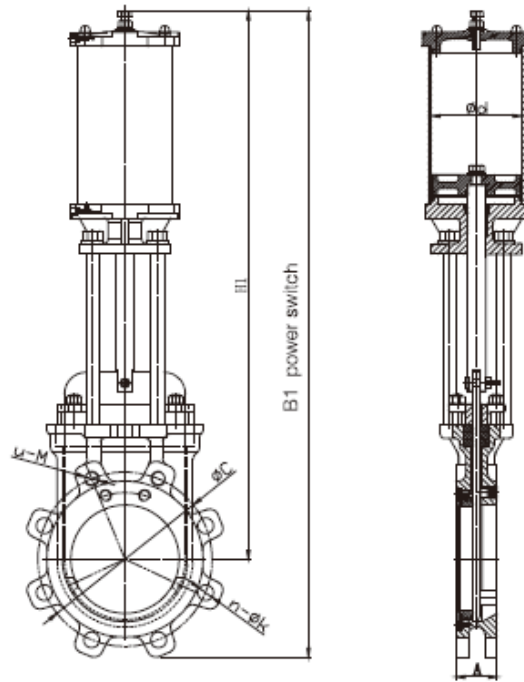

DN	A	H1	B1	ϕ d	PN16			150Lb	
					C	n-ϕ K	u-M	C	u-M
50	48	460	520	80	ϕ 125	2-ϕ 18	2-M16	ϕ 120.5	4-5/8-11NC
65	48	530	595	80	ϕ 145	2-ϕ 18	2-M16	ϕ 139.5	4-5/8-11NC
80	51	550	650	100	ϕ 160	6-ϕ 18	2-M16	ϕ 152.5	4-5/8-11NC
100	51	610	715	100	ϕ 180	6-ϕ 18	2-M16	ϕ 190.5	8-5/8-11NC
125	57	675	795	125	ϕ 210	6-ϕ 18	2-M16	ϕ 216	8-3/4-10NC
150	57	760	890	125	ϕ 240	6-ϕ 22	2-M20	ϕ 241.5	8-3/4-10NC
200	70	950	1115	160	ϕ 295	8-ϕ 22	4-M20	ϕ 298.5	8-3/4-10NC
250	70	1135	1340	200	ϕ 355	8-ϕ 26	4-M24	ϕ 362	12-7/8-9NC
300	76	1320	1545	250	ϕ 410	8-ϕ 26	4-M24	ϕ 432	12-7/8-9NC
350	76	1500	1750	300	ϕ 470	10-ϕ 26	6-M24	ϕ 476.3	12-1-8NC
400	89	1670	1925	300	ϕ 525	10-ϕ 30	6-M27	ϕ 540	16-1-8NC
450	89	1860	2170	320	ϕ 585	12-ϕ 30	8-M27	ϕ 578	16-1 1/8-7NC
500	114	2020	2380	350	ϕ 650	12-ϕ 33	8-M30	ϕ 635	20-1 1/8-7NC
600	114	2290	2680	350	ϕ 770	12-ϕ 36	8-M33	ϕ 749.3	20-1 1/4-6NC



KAVAL INDUSTRIES

142 Cranarch Landing Se Calgary,
Alberta, Canada. T3M 0Z7
Tel : 001-403-456-4596
Fax : 001-403-456-4596

www.kaval.ca